

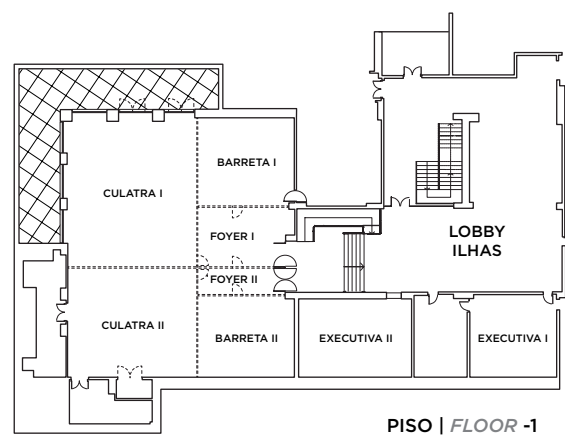

## SALAS DE REUNIÃO MEETING ROOMS

- \_ 15 salas multifuncionais
- \_ Capacidade máxima da maior sala - 700 pax/plateia
- \_ Luz natural na maioria das salas
- \_ Aluguer de material audiovisual de última geração, incluindo sistema de audioconferência de alta voz
- \_ Ligação de internet wireless e de banda larga
- \_ Garagem com 50 lugares

- \_ 15 multi-purpose meeting rooms
- \_ Maximum capacity of largest room - 700 pax/theatre
- \_ Natural light in all rooms, with view to the Ria or Village
- \_ Rental of state-of-the-art audiovisual material, including speakerphone audio conferencing system
- \_ Wireless internet connection and broadband
- \_ Garage with 50 spaces



## SALAS ROOMS

(CxLxA)   (LxWxH)	M <sup>2</sup>	PLATEIA THEATRE	ESCOLA SCHOOL	EM U U SHAPE	RECEPÇÃO RECEPTION	BANQUETE BANQUET	CABARET CABARET	BUFFET BUFFET	MESA ÚNICA SINGLE TABLE
-------------------	----------------	--------------------	------------------	-----------------	-----------------------	---------------------	--------------------	------------------	----------------------------

### PISO | FLOOR 1

Dunas	7,70x7,60x2,95	59	50	27	21	-	40	-	23
Sapal	9,83x4,41x2,95	43	36	27	15	-	30	-	21
Laguna	6,05x7,60x2,95	46	54	25	30	-	40	-	21
Executive Lounge	7,45x2,83x2,95	21	24	12	-	-	17	-	18
Dunas + Laguna		93	144	72	42	-	80	-	38
Dunas + Laguna + Sapal		135	-	-	-	-	100	-	-

### PISO | FLOOR 0

Praias	22,45x25,70x3,50	577	700	360	102	-	500	-	132
Armona I	11,47x11,16x3,50	128	160	90	39	-	90	-	54
Armona II	11,47x11,16x3,50	128	160	90	36	-	90	-	46
Armona I + II	22,45x11,16x3,50	250	320	180	54	-	200	-	84
Farol I	7,40x7,63x3,50	56	50	32	18	-	40	-	24
Farol II	7,40x7,11x3,50	53	45	32	18	-	40	-	24
Farol I + II	7,40x14,81x3,50	109	100	72	42	-	70	-	54
Armona I + Farol I & II + Foyer I	11,47x25,70x3,50	295	350	180	84	-	240	-	96
Deserta I	7,32x7,63x3,50	56	40	32	18	-	40	-	24
Deserta II	7,32x6,50x3,50	47	35	32	18	-	40	-	24
Deserta I & II	7,32x14,60x3,50	107	100	72	42	-	80	-	54
Armona II + Deserta I & II + Foyer II	11x25,70x3,50	283	350	180	84	-	240	-	96
Foyer I	3,75x14,60x3,50	55	-	-	-	-	-	-	-
Foyer II	3,75x14,60x3,50	55	-	-	-	-	-	-	-

### PISO | FLOOR -1

Ilhas	22,60x19,16x3	433	500	330	78	-	280	-	108
Culatra I	12,91x11,61x3	150	200	90	39	-	100	-	54
Culatra II	9,61x11,61x3	111	150	108	30	-	80	-	42
Barreta I	7,43x8,22x3	61	50	36	27	-	40	-	36
Barreta II	7x7,87x3	55	40	27	21	-	40	-	30
Foyer I	5,12x7,28x3	37	-	-	-	-	-	-	-
Foyer II	12,55x7,49x3	10	-	-	-	-	-	-	-
Culatra I + Barreta I + Foyer I	12,95x19,10x3	247	300	150	63	-	150	-	78
Culatra II + Barreta II + Foyer II	9,64x19,10x3	184	200	120	60	-	120	-	72

