



REAL MARINA
HOTEL & SPA
★★★★★
RIA FORMOSA - OLHÃO

SALAS
ROOMS

↑ ↓
(CxLxA) | (LxWxH)
DIMENSÕES
DIMENSIONS



M²



PLATEIA
THEATRE



ESCOLA
SCHOOL



EM U
U SHAPE



RECEPÇÃO
RECEPTION



BANQUETE
BANQUET



CABARET
CABARET



BUFFET
BUFFET



MESA ÚNICA
SINGLE TABLE

PISO | FLOOR 1

Dunas	7,70x7,60x2,95	59	15	12	10	-	10	-	-	9
Sapal	9,83x4,41x2,95	43	15	9	5	-	10	-	-	9
Laguna	6,05x7,60x2,95	46	12	9	7	-	10	-	-	9
Executive Lounge	7,45x2,83x2,95	21	7	4	-	-	3	-	-	6
Dunas + Laguna		93	30	24	14	-	30	-	-	2
Dunas + Laguna + Sapal		135	-	-	-	-	30	-	-	-

PISO | FLOOR 0

Praias	22,45x25,70x3,50	577	210	180	34	-	200	-	-	40
Armona I	11,47x11,16x3,50	128	36	26	12	-	40	-	-	16
Armona II	11,47x11,16x3,50	128	36	26	13	-	40	-	-	16
Armona I + II	22,45x11,16x3,50	250	78	60	25	-	90	-	-	24
Farol I	7,40x7,63x3,50	56	15	12	9	-	10	-	-	8
Farol II	7,40x7,11x3,50	53	15	12	9	-	10	-	-	8
Farol I + II	7,40x14,81x3,50	109	40	21	14	-	30	-	-	12
Armona I + Farol I & II + Foyer I	11,47x25,70x3,50	295	105	60	28	-	100	-	-	28
Deserta I	7,32x7,63x3,50	56	15	12	9	-	10	-	-	8
Deserta II	7,32x6,50x3,50	47	15	12	9	-	10	-	-	8
Deserta I & II	7,32x14,60x3,50	107	40	21	14	-	30	-	-	12
Armona II + Deserta I & II + Foyer II	11x25,70x3,50	283	105	60	28	-	100	-	-	28
Foyer I	3,75x14,60x3,50	55	-	-	-	-	-	-	-	-
Foyer II	3,75x14,60x3,50	55	-	-	-	-	-	-	-	-

PISO | FLOOR -1

Ilhas	22,60x19,16x3	433	120	90	26	-	120	-	-	30
Culatra I	12,91x11,61x3	150	42	26	13	-	40	-	-	12
Culatra II	9,61x11,61x3	111	30	30	10	-	30	-	-	14
Barreta I	7,43x8,22x3	61	20	16	9	-	10	-	-	12
Barreta II	7x7,87x3	55	20	16	7	-	10	-	-	12
Foyer I	5,12x7,28x3	37	-	-	-	-	-	-	-	-
Foyer II	12,55x7,49x3	10	-	-	-	-	-	-	-	-
Culatra I + Barreta I + Foyer I	12,95x19,10x3	247	70	44	21	-	70	-	-	21
Culatra II + Barreta II + Foyer II	9,64x19,10x3	184	50	38	20	-	50	-	-	21

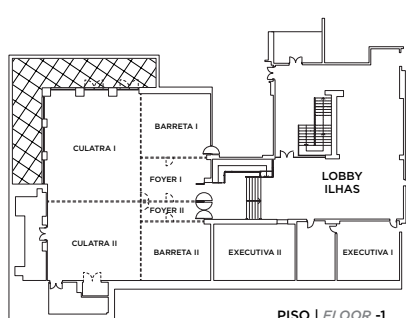

PISO | FLOOR -1

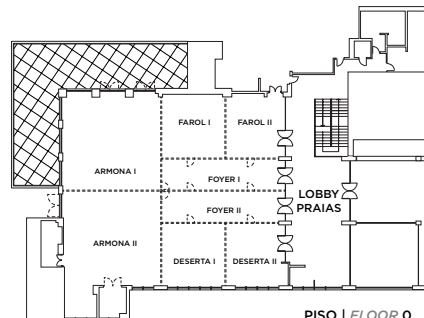

PISO | FLOOR 0

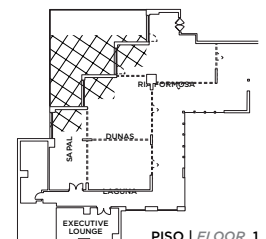

PISO | FLOOR 1

EXTERIOR

SALAS DE REUNIÃO
MEETING ROOMS